



**File Name:** 6se3212-0da40 manual.pdf

**Size:** 2772 KB

**Type:** PDF, ePub, eBook

**Category:** Book

**Uploaded:** 3 May 2019, 15:31 PM

**Rating:** 4.6/5 from 790 votes.

**Status:** AVAILABLE

Last checked: 14 Minutes ago!

**In order to read or download 6se3212-0da40 manual ebook, you need to create a FREE account.**

[\*\*Download Now!\*\*](#)

eBook includes PDF, ePub and Kindle version

[Register a free 1 month Trial Account.](#)

[Download as many books as you like \(Personal use\)](#)

[Cancel the membership at any time if not satisfied.](#)

[Join Over 80000 Happy Readers](#)

### Book Descriptions:

We have made it easy for you to find a PDF Ebooks without any digging. And by having access to our ebooks online or by storing it on your computer, you have convenient answers with 6se3212-0da40 manual . To get started finding 6se3212-0da40 manual , you are right to find our website which has a comprehensive collection of manuals listed.

Our library is the biggest of these that have literally hundreds of thousands of different products represented.



## Book Descriptions:

# 6se3212-0da40 manual

Discover everything Scribd has to offer, including books and audiobooks from major publishers. Start Free Trial Cancel anytime. Report this Document Download Now save Save siemensmicromastervectormanual.pdf For Later 0 ratings 0% found this document useful 0 votes 528 views 79 pages siemensmicromastervectormanual.pdf Uploaded by Carlos Description Full description save Save siemensmicromastervectormanual.pdf For Later 0% 0% found this document useful, Mark this document as useful 0% 0% found this document not useful, Mark this document as not useful Embed Share Print Download Now Jump to Page You are on page 1 of 79 Search inside document Browse Books Site Directory Site Language English Change Language English Change Language. Something went wrong. Cancel Thanks, well look into this. All Rights Reserved. User Agreement, Privacy, Cookies and AdChoice Norton Secured powered by Verisign. Please upgrade your browser to improve your experience. Please enable cookies in your browser to submit your RFQ online. You may also use our online sharedmodalphonenumber Choisissez parmi notre inventaire de surstock et economiser de l'argent sur 6SE32120DA40. Santa Clara Systems se vend 23,982 articles de Siemens. Veuillez chercher des articles similaires pour plus d'informations relative a ce produit.Santa Clara Systems achete le produit obsolete ou excedentaire et n'est ni un distributeur agree ni un representant des fabricants de controle d'automatisation industrielle cotees et donc n'est limite ni par prix OEM ni par des restrictions territoriales. If its all Siemens hardware they may already have some software written for it that you just configure. I dont know about the 200, the 300 is definitely capable. You will need different software for either version Microwin for the 200 or STEP 7 for the 300 You will also need separate software for the HMI. Probably WinCC Flex. With an OP27 you may be able to use ProTool its a little older than WinCC flex and is for older HMI panels.<http://www.incomet.com.ar/images/elementary-linear-algebra-2nd-edition-solution-manual-pdf.xml>

- **6se3212-0da40 manual, 6se3212-0da40 manual, 6se3212-0da40 manual.**

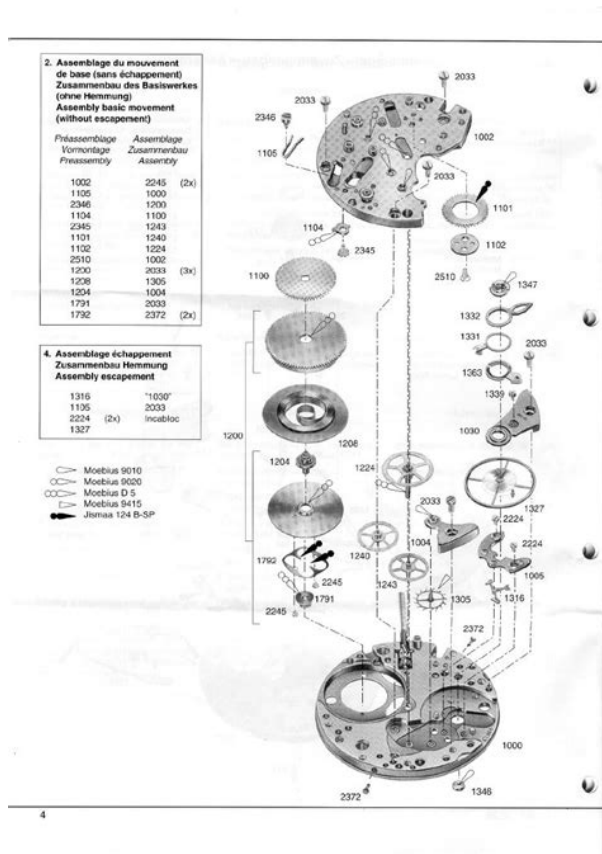

Since you are talking about an HMI and a Drive you can go several different ways. The entire system can be setup on Profibus which will limit how much feild wiring is needed. That said your drive will have to be profibus compatible. My suggestion is to call your local Siemens distributor and talk to him in detail on what you need. Not knowing your process makes it hard to know what level of control you need. I am attaching a web page from Siemens. I use this alot. It allows me to get spefecif info on the various componets that Siemens sales. After you talk to your rep. Post his suggestions and several here can help you fill in the blanks on how to make it work together. FYI.pertaining to your question on how is the best way to control a drive.it is really dependant on what you want to do. Is precise speed needed, torque, or some other factor. web page The one you need will depend specifically on your applications. Do you need servo control, or are you just going to run a conveyor. Ive worked with a Siemens 611U drive coupled to servo motors controlled by a PLC over Profibus. They also have Masterdrive and Micromaster. They tend to group these under different product family names SIMORDRIVE The 611U SIMOREG and SIMOVERT the Masterdrives and Micromasters SINAMICS even more drives Again, which to use depends on exactly what your application is. If its something simpler a SIMOREG or SIMOVERT system might do ago. More complex you may need a 611U, which would be overkill for a simple project. I would suggest just going to the Siemens Service and Support website, putting in some of the family names and reading about the different capabilities to try to decide what you need, or contact a local Siemens rep and tell him what it is you need to do. Or just keep posting here, the more specifics you can provide the better. If you want to use Siemens drives the micromaster has two protocols you can use to communicate to the plc.<http://decorinter.ru/img/uploaded/elementary-library-policies-and-procedures-manual.xml>

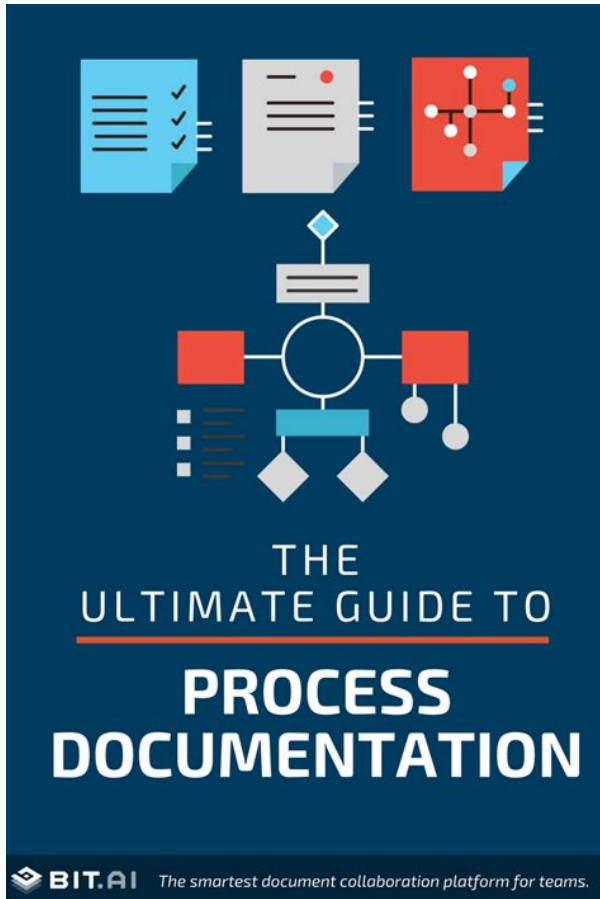

One is older and less expensive called USS protocol, the other is Profibus. If you want to go inexpensive use a 200 PLC with uss. If you have so money in your budget then the 300 series PLC with profibus is the way to go. The following link will take you to a Siemens Application file that describes control of a MM4 drive using an operator panel. Study these, they can all be adapted to your purposes, but you still have a lot top learn before you make this work properly. Hoep this helps, Daniel Chartier Does anyone know about siemens plc s7300.am doing project on plc.could u please help me out whatever u know about siemens plc. Kindly please help me out these question.if anyone know about this.am waitin for ur valuable information.thanks in advance The drive has its own powerstage inbuilt, so you do not have to worry about that at this point. I do not recomend you use PWM connection between your PLC and the drive. Using standard PLC analog and digital outputs you can give commands to the drive, as long as it has been parametrized and wired properly. The drive accepts digital control with set frequencies or analog control. This sets up the inverter for clockwise rotation of the motor shaft default. NOTE this could be done through a digital output from PLC 2 Secure all covers to the unit and then apply mains power to the inverter. Turn the potentiometer or adjust the analogue input control voltage until the desired frequency is displayed on the inverter. Note here you could use a digital and analog output from the PLC to give you analog control of the drive Micromaster 3 Getting started manual Hope this helps, Daniel Chartier Most of the questions you are asking find their answers in that document. For example, look at the attachment I have taken from that manual. You will see that there are 3 possibilities of controlling this drive, through digital inputs, analog inputs and USS protocol. No pulse input for PWM.

If you choose to use digital inputs parameter P006 to 000, you will have to connect a 24 V DC digital output from the PLC between pins 5 and 9 to control Digital Input 1 selected by P007 set to 1, as described in the extract in my previous post. Connecting between 6 and 9 gives you control of DIN 2. What speed command will be sent to the motor will depend on the parameters that you have selected for the drive in P005, in Hz. Analog outputs from your PLC can be programmed to operate the drive too. Look at the information on analog control in the manual. Do you understand now the

relationship between physical commands and parameters. For example you need to enable DIN 1 P007 for the digital command pins 5 and 9 to operate correctly. The set speed selected for DIN 1 will be selected by you in parameter P005. Your question on the connection of the internal RS485 is found on this page also if you decide to use USS protocol then you are limited in the selection of other elements using the external port, such as a OPM2 operator panel. USS is a control protocol you can use from a S7200 CPU there is an add-on library for it that will allow you to send control and speed command in real-time to this drive, serially no Profibus module required on the drive or on the PC without having to control through digital or analog inputs. Again, look at the manual, and try to understand it properly, it is the best advice I can give you. Hope this helps, Daniel Chartier Once you install that, library will appear in Microwin. How to connect the Profibus to which terminal of the drive is explained in microwin help. Attached is file giving you programming example of connecting to drive using USS taken from Microwin HELP. USS is add-on to microwin and you need to purchase it. Check this I have done projects using Siemens S7 200 226 PLC for control servo axis Master Drive and VFD Micro master through TP170micro HMI.

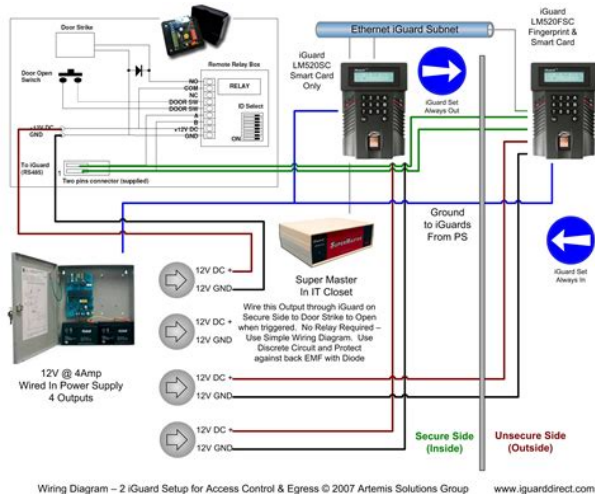

<http://www.jfvtransports.com/home/content/bose-powered-acoustimass-3-manual>

If you interested I will send details to you Now I think you want to finalize hardware and riteup for your project I mean, what you want to do with those Hardware. Riyaz. This offers the user the benefits of hightorque and dynamic performance across a broad spectrum of applications. A parallel range of nonvector drives, the MICROMASTER, from 120W to 7.5kW is ideal for embedded control of low end machines. For the ultimate in variable speed drive packaging, the COMBIMASTER is on offer see Section 8, combining motor and inverter in one compact unit. The CEMark on the units demonstrates this conformity. A declaration of conformity can be issued. If the guidelines on installation to reduce the effects of EMI are followed, the relevant requirements for CE certification of the machine will be met. Sold strictly FOR PARTS. Please Note cant rotate motor in " This includes items that are defective in ways that render them difficult to use, items that require service or repair, or items missing essential components. See the sellers listing for full details. Sold strictly FOR PARTS. Please Note cant rotate motor in reverse direction and mounting latch is missing. ". The fabric is replcia watches uk in quality and easy rolex replica care for, so that the owner does not have to rack his brains for how to maintain the bag. Memory Card TD Starter Kit Soft Comfort V6 Software Trial Licence XP Step7 Pro XP XP Step7Pro WinFlex Adv Flow Straightener DC Servo Drive Transistor Controller for Transistor Controller for We are specialized in industrial automation equipments repair supply and PLC programming field with highly skilled technical team supported with motivated customer service and sales department. We are not an authorized distributor or representative for the listed manufacturers. Brand names, brands, and designated trademarks

appearing herein are the property of their respective owners. View cart for details.

<http://instalaciones-martinez.com/images/canon-eos-50d-pdf-manual.pdf>

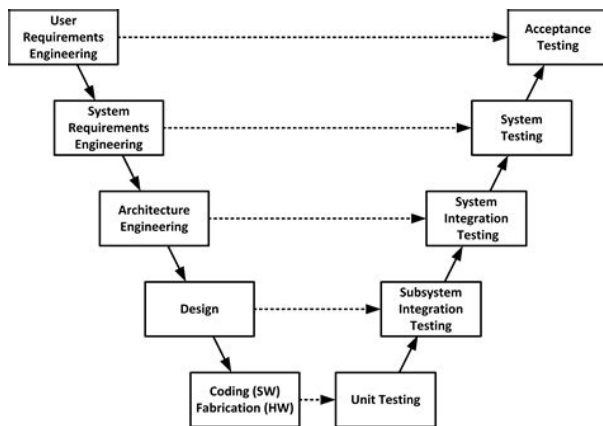

Learn more opens in a new window or tab This amount is subject to change until you make payment. For additional information, see the Global Shipping Program terms and conditions opens in a new window or tab This amount is subject to change until you make payment. If you reside in an EU member state besides UK, import VAT on this purchase is not recoverable. For additional information, see the Global Shipping Program terms and conditions opens in a new window or tab Learn More opens in a new window or tab Learn More opens in a new window or tab Learn More opens in a new window or tab Learn More opens in a new window or tab Learn More opens in a new window or tab The item may have some signs of cosmetic wear, but is fully operational and functions as intended. This item may be a floor model or store return that has been used. See the seller's listing for full details and description of any imperfections. Contact the seller opens in a new window or tab and request shipping to your location. Please enter a valid postal code. Please enter a number less than or equal to 8. All Rights Reserved. The term SIMOVERT is used by Siemens to identify a Siemens MOtor inVERTer AC drive. AC drives receive AC power and convert it to an adjustable frequency, adjustable voltage output for controlling motor operation. A typical inverter receives 480 VAC, threephase, 60 Hz input power and provides power to the motor which can be steplessly adjusted through the speed range. The three common inverter types are the variable voltage inverter VVI, current source inverter CSI, and pulse width modulation PWM. Another type of AC drive is a cycloconverter. These are commonly used for very large motors and will not be described in this course. All AC drives convert AC to DC, and then through various switching techniques invert the DC into a variable voltage, variable frequency output.

<http://www.dimalcco.com/images/canon-eos-580ex-ii-user-manual.pdf>



37 Variable Voltage Inverter VVI The variable voltage inverter VVI uses an SCR converter bridge to convert the incoming AC voltage into DC. The SCRs provide a means of controlling the value of the rectified DC voltage from 0 to approximately 600 VDC. The L1 choke and C1 capacitors make up the DC link section and smooth the converted DC voltage. The inverter section consists of six switching devices. Various devices can be used such as thyristors, bipolar transistors, MOSFETS, and IGBTs. The following schematic shows an inverter that utilizes bipolar transistors. Control logic not shown uses a microprocessor to switch the transistors on and off providing a variable voltage and frequency to the motor. This type of switching is often referred to as sixstep because it takes six 60 steps to complete one 360 cycle. Although the motor prefers a smooth sine wave, a sixstep output can be satisfactorily used. The main disadvantage is torque pulsation which occurs each time a switching device, such as a bipolar transistor, is switched. The pulsations can be noticeable at low speeds as speed variations in the motor. These speed variations are sometimes referred to as cogging. The nonsinusoidal current waveform causes extra heating in the motor requiring a motor derating. 38 Current Source Inverter The current source inverter CSI uses an SCR input to produce a variable voltage DC link. The inverter section also uses SCRs for switching the output to the motor. The current source inverter controls the current in the motor. The motor must be carefully matched to the drive. Current spikes, caused by switching, can be seen in the output. At low speeds current pulses can causes the motor to cog. 39 Pulse Width Modulation Pulse width modulation PWM drives, like the Siemens MICROMASTER, MICROMASTER Vector, MIDIMASTER Vector, MICROMASTER 420, and MASTERDRIVE VC, provide a more sinusoidal current output to control frequency and voltage supplied to an AC motor.

PWM drives are more efficient and typically provide higher levels of performance. A basic PWM drive consists of a converter, DC link, control logic, and an inverter. Converter and DC Link The converter section consists of a fixed diode bridge rectifier which converts the three-phase power supply to a DC voltage. The L1 choke and C1 capacitors smooth the converted DC voltage. The rectified DC value is approximately 1.35 times the line-to-line value of the supply voltage. The rectified DC value is approximately 650 VDC for a 480 VAC supply. 40 Control Logic and Inverter Output voltage and frequency to the motor are controlled by the control logic and inverter section. Various devices can be used such as thyristors, bipolar transistors, MOSFETS and IGBTs. The

following schematic shows an inverter that utilizes IGBTs. The control logic uses a microprocessor to switch the IGBTs on and off providing a variable voltage and frequency to the motor. IGBTs insulated gate bipolar transistor provide a high switching speed necessary for PWM inverter operation. IGBTs are capable of switching on and off several thousand times a second. An IGBT can turn on in less than 400 nanoseconds and off in approximately 500 nanoseconds. An IGBT consists of a gate, collector and an emitter. This is similar to closing a switch. Current will flow between the collector and emitter. An IGBT is turned off by removing the positive voltage from the gate. During the off state the IGBT gate voltage is normally held at a small negative voltage 15 VDC to prevent the device from turning on. 41 Using Switching Devices to Develop AC Output In the following example, one phase of a threephase output is used to show how an AC voltage can be developed. Switches replace the IGBTs. A voltage that alternates between positive and negative is developed by opening and closing switches in a specific sequence. The output voltage between A and B is positive. The difference of potential from A to B is zero.

<http://www.lavalledesign.com/wp-content/plugins/formcraft/file-upload/server/content/files/16274dd0041fa7---brother-intellifax-1800c-user-manual.pdf>

The output voltage is zero. The output voltage from A to B is negative. The voltage is dependent on the value of the DC voltage and the frequency is dependent on the speed of the switching. An AC sine wave has been added to the output AB to show how AC is simulated. 42 PWM Output There are several PWM modulation techniques. It is beyond the scope of this book to describe them all in detail. The following text and illustrations describe a typical pulse width modulation method. An IGBT or other type switching device can be switched on connecting the motor to the positive value of DC voltage 650 VDC from the converter. Current flows in the motor. The IGBT is switched on for a short period of time, allowing only a small amount of current to build up in the motor and then switched off. The IGBT is switched on and left on for progressively longer periods of time, allowing current to build up to higher levels until current in the motor reaches a peak. The IGBT is then switched on for progressively shorter periods of time, decreasing current build up in the motor. The negative half of the sine wave is generated by switching an IGBT connected to the negative value of the converted DC voltage. 43 PWM Voltage and Current The more sinusoidal current output produced by the PWM reduces the torque pulsations, low speed motor cogging, and motor losses noticeable when using a sixstep output. The voltage and frequency is controlled electronically by circuitry within the AC drive. The fixed DC voltage 650 VDC is modulated or clipped with this method to provide a variable voltage and frequency. At low output frequencies a low output voltage is required. The switching devices are turned on for shorter periods of time. Voltage and current build up in the motor is low. At high output frequencies a high voltage is required. The switching devices are turned on for longer periods of time.

The Siemens MICROMASTER, MICROMASTER VECTOR and MIDIMASTER Vector are adjustable frequency AC drives that use a builtin microprocessor to control the operation of the drive. The inverters are very compact and designed for operation anywhere in the world. 46 Enclosures The National Electrical Manufacturers Association NEMA has specified standards for equipment enclosures. The MICROMASTER and MICROMASTER Vector are supplied in a protected chassis and a NEMA Type 1 enclosure. Indoor or outdoor use primarily to provide a degree of protection against windblown dust and rain, splashing water, hosedirected water, and damage from external ice formation. Indoor or outdoor use primarily to provide a degree of protection against corrosion, windblown dust and rain, splashing water, hosedirected water, and damage from external ice formation. Please click here to register! PLC Simulator FREE.If its all Siemens hardware they may already have some software written for it that you just configure. With an OP27 you may be able to use ProTool its a little older than WinCC flex and is for older HMI panels.Since you are talking about an HMI and a Drive you can go several different ways. Or just keep posting here, the more specifics

you can provide the better. If you want to use Siemens drives the micromaster has two protocols you can use to communicate to the plc. If you have so money in your budget then the 300 series PLC with profibus is the way to go. The following link will take you to a Siemens Application file that describes control of a MM4 drive using an operator panel. Hoep this helps, Daniel Chartier Does anyone know about siemens plc s7300. am doing project on plc. could u please help me out whatever u know about siemens plc. Note here you could use a digital and analog output from the PLC to give you analog control of the drive Micromaster 3 Getting started manual Hope this helps, Daniel Chartier Most of the questions you are asking find their answers in that document.

Hope this helps, Daniel Chartier.

<http://www.familyreunionapp.com/family/events/bose-powered-acoustimass-3-manual>